

BM #94 - SET 1/2" I.P.
W/DELTA CAP
N:129927.6538
E:2103895.0972
EL: 1238.00

CP #95 -
MAG NAIL
N:129906.7587
E:2103893.4375
EL: 1236.53

CP #97 -
CUT "+- IN TC
N:129914.3219
E:2104187.8983
EL: 1237.62

CP #98 -
CUT "+- IN CONC
N:129837.5801
E:2104196.7357
EL: 1237.06

CP #96 -
MAG NAIL IN CONC
N:129743.1233
E:2104121.4059
EL: 1236.96

CP #99 -
MAG NAIL IN CONC
N:129746.0648
E:2104196.9036
EL: 1236.82

CP #1000
1/2" I.P. W/ DELTA CAP
N:129601.8430
E:2104362.4110
EL: 1233.95

CP #1001
1/2" I.P. W/ DELTA CAP
N:129598.902
E:2104178.655
EL: 1236.39

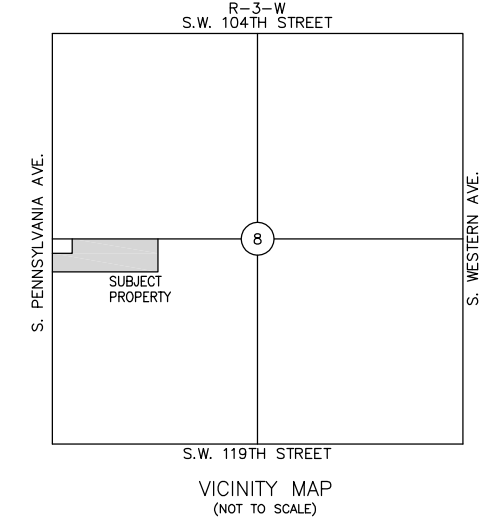

LEGEND:

- - - BUILDING OVERHANG
- - - CHAIN LINK FENCE
- - - OTHER FENCE
- - - FIBER OPTIC CABLE
- - - GAS LINE
- - - GAS LINE
- - - OVERHEAD ELECTRIC
- - - UNDERGROUND ELECTRIC
- - - SANITARY SEWER
- - - STORM SEWER
- - - TELEPHONE CABLE
- - - WATER
- CONC 3 WIRES
- ELEC CONDUIT
- ELEC MANHOLE
- ELEC FULL BOX
- FIRE HYDRANT
- SET MONUMENT
- FOUND MONUMENT
- GAS METER
- IRRIGATION VALVE
- LIGHT POLE
- POWER POLE
- ROOF DRAIN
- SANITARY SEWER MANHOLE
- SANITARY SEWER CLEANOUT
- SON
- STORM DRAIN MANHOLE
- TEL RISER
- TRAFFIC CONTROL BOX
- TRANSFORMER OR TRANSFORMER
- WATER VALVE
- WATER METER

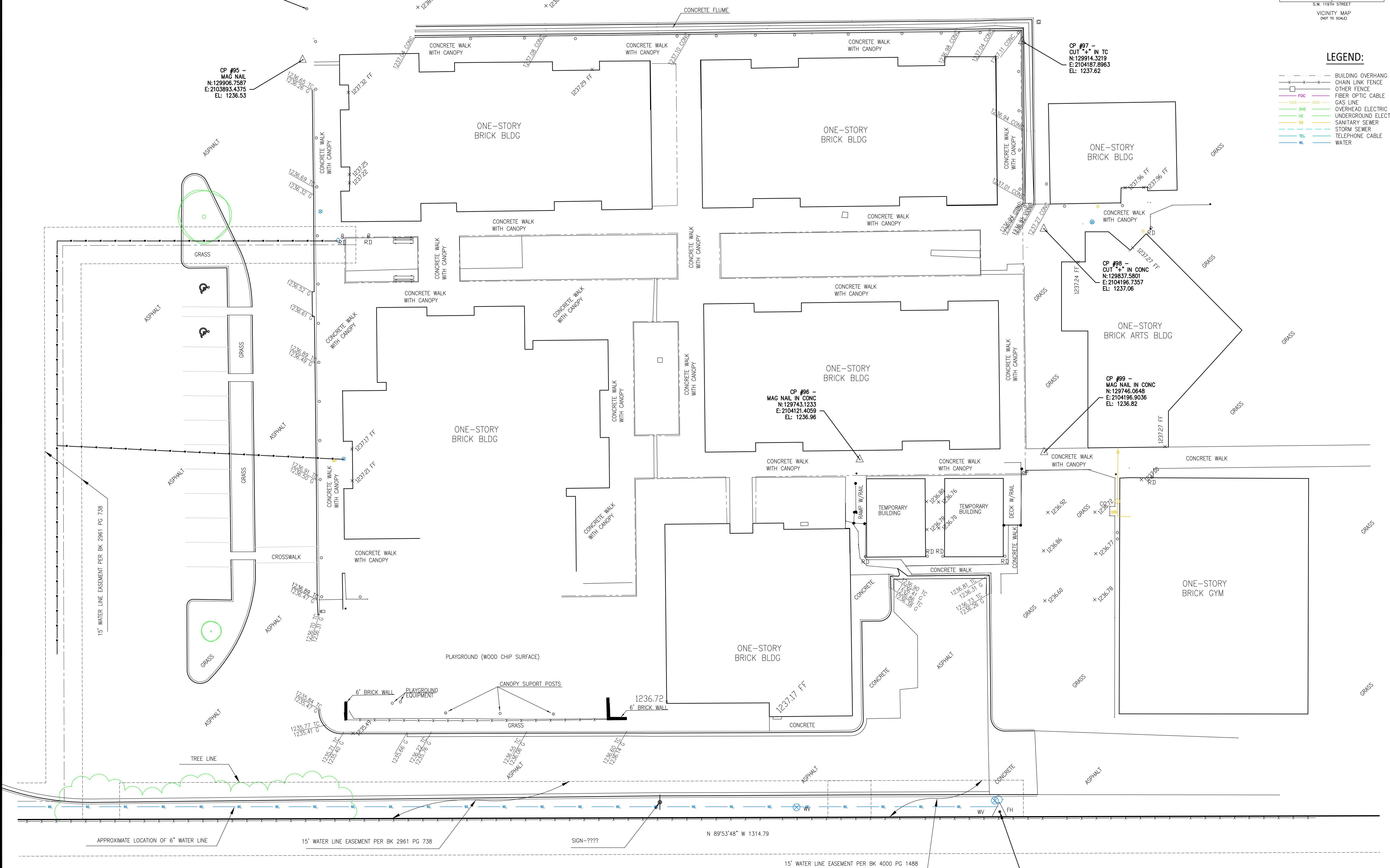

This drawing is an instrument of service and shall remain the property of Delta Surveying Company. It is not to be used for any other purpose without the written consent of Delta Surveying Company. The user of this drawing shall be responsible for verifying the accuracy of the information shown hereon. Delta Surveying Company does not warrant the accuracy of the information shown hereon. Any reproduction or use of this drawing without the written consent of Delta Surveying Company is prohibited. Any reproduction or use of this drawing without the written consent of Delta Surveying Company is prohibited. Any reproduction or use of this drawing without the written consent of Delta Surveying Company is prohibited.

No.	Date	Description

Project No. 122-44-20
Designed By PAT
Drawn By PAT
Approved By KRS
Blk. No.
Date: 04/24/20

DELTA
SURVEYING CO.
201 N.E. 38TH TERRACE, SUITE 1, OKLAHOMA CITY, OKLAHOMA 73105
TEL. 405-789-5983 FAX 405-789-5884
CA # 890 Expires 6-30-20

TOPOGRAPHIC SURVEY
RED OAK ELEMENTARY SCHOOL
11224 S Pennsylvania Ave
Oklahoma City, OK 73170

Sheet No. 1 of 1

Kenneth R. Shuford
Okla. L.S. #1360

This Plot of Survey Meets The Oklahoma Minimum Standards For The Practice Of Land Surveying As Adopted By The Oklahoma State Board Of Registration For Professional Engineers And Land Surveyors.

Underground utilities as shown on drawing were located in the field by above ground and visible appurtenances only. Other utilities may exist that do not have above ground appurtenances or other features to make them visible to the surveyor. Oklahoma One Call, Inc. "CALL OKIE", should be consulted for additional information.